

N

INEZ M. HANNON
REF. DWG. NO. I-442

JOHN B. SMITH

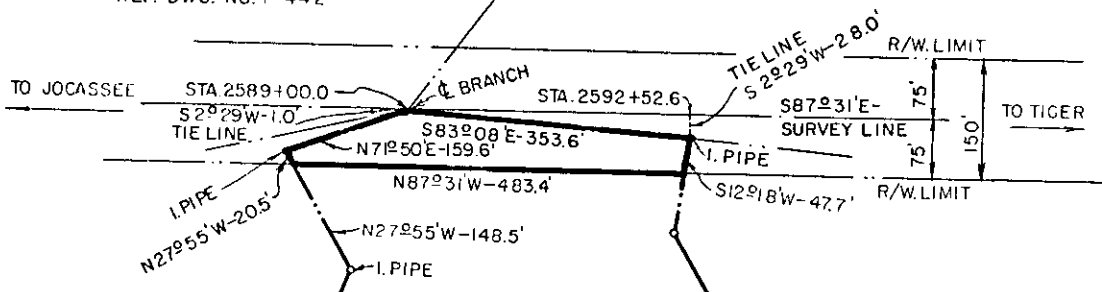

LOUIE M DOBBINS
REF. DWG. NO. I-580

CLYDE BARBARE
REF. DWG. NO. I-710

LILLIAN E. BARBARE
9.8 ACRES

DUKE POWER COMPANY
JOCASSEE-TIGER
TRANSMISSION LINE
CROSSING PROPERTY OF
LILLIAN E. BARBARE
NEAR: GREER, S.C.
ONEAL TOWNSHIP
GREENVILLE COUNTY

Recorded June 2, 1971 At 3:39 P.M. # 29109

SCALE 1" = 200'
BOOKED 1197

AUGUST 7, 1970
FILE NO. I 704

TO NO. 702 120 A